

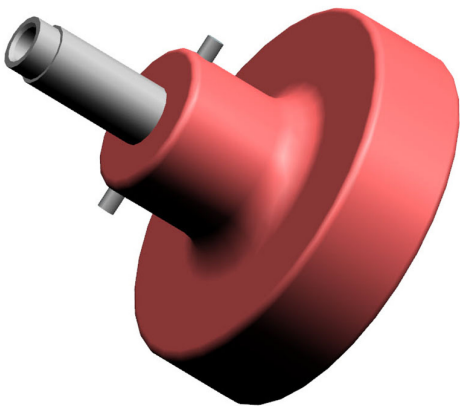

Part Number : [1731121763](#)
Product Description : FCT Locator for Size 20
Contacts, Socket
Series Number : 173112
Status : Active
Product Category : Crimp Presses and Crimp
Hand Tools
Engineering Number : 1731121763-FCT



Product Environment Compliance

Compliance

GADSL/IMDS	Not Relevant
China RoHS	Not Reviewed per SJ/T 11365-2006
EU ELV	Not Relevant
Low-Halogen Status	Not Reviewed per IEC 61249-2-21
REACH SVHC	Not Reviewed per D(2024)7663-DC (21 Jan 2025)
EU RoHS	Not Reviewed per EU 2015/863

Multiple Part Product Compliance Statements

- Eu RoHS
- REACH SVHC
- Low-Halogen

Multiple Part Industry Compliance Documents

- IPC 1752A Class C
- IPC 1752A Class D
- Molex Product Compliance Declaration
- IEC-62474
- chemSHERPA (xml)

EU RoHS Certificate of Compliance

Part Details

General

Status	Active
Category	Crimp Presses and Crimp Hand Tools
Series	173112
Description	FCT Locator for Size 20 Contacts, Socket
Function	Locator
Geographic Area	Global
Level of Automation	Manual
Product Name	FCT Products
Tool Type	Hand Crimp Tool
UPC	193264550623
Warranty Disclaimer	<p>CAUTION: Molex tooling crimp specifications are valid only when used with Molex terminals and tooling manufactured by Molex and sold by Molex or authorized distributors ("Molex Tooling"). When using tooling other than Molex Tooling with Molex specific connector systems listed in our ATS documents, the Molex tooling qualification does not apply and the responsibility for full qualification of the connector system is that of the customer. Molex accepts no liability for connector performance or tooling support where tooling other than Molex Tooling is used or where Molex Tooling is modified.</p>

Physical

Net Weight	13.500/g
------------	----------

Use with Part(s)

Description	Part Number
FCT Hand Crimp Tool, Mini Frame, 8-Step Adjust	<u>1731121730</u>

Applicable Parts

Description	Part Number
-------------	-------------

FCT Machined Contact, Female, Crimp, 0.20µm Gold Plating, Split Tine, 24-20 AWG, 500 Pieces	<u>1731120214</u>
FCT Machined Contact, Female, Crimp, 0.80µm Gold Plating, Split Tine, 24-20 AWG, 500 Pieces	<u>1731120215</u>
FCT Machined Contact, Female, Crimp, 1.30µm Gold Plating, Split Tine, 24-20 AWG, 500 Pieces	<u>1731120216</u>
FCT Machined Contact, Female, Crimp, 0.20µm Gold Plating, Split Tine, 22-18 AWG, 500 Pieces	<u>1731120217</u>
FCT Machined Contact, Female, Crimp, 0.80µm Gold Plating, Split Tine, 22-18 AWG, 500 Pieces	<u>1731120218</u>
FCT Machined Contact, Female, Crimp, 1.30µm Gold Plating, Split Tine, 22-18 AWG, 500 Pieces	<u>1731120219</u>
FCT Machined Contact, Female, Crimp, 0.20µm Gold Plating, Split Tine, 28-26 AWG, 500 Pieces	<u>1731120220</u>
FCT Machined Contact, Female, Crimp, 0.80µm Gold Plating, Split Tine, 28-26 AWG, 500 Pieces	<u>1731120221</u>
FCT Machined Contact, Female, Crimp, 0.20µm Gold Plating, Split Tine, 24-20 AWG, 1000 Pieces	<u>1731120730</u>
FCT Machined Contact, Female, Crimp, 0.20µm Gold Plating, Split Tine, 24-20 AWG, 5000 Pieces	<u>1731120731</u>
FCT Machined Contact, Female, Crimp, 0.80µm Gold Plating, Split Tine, 24-20 AWG, 1000 Pieces	<u>1731120732</u>
FCT Machined Contact, Female, Crimp, 0.80µm Gold Plating, Split Tine, 24-20 AWG, 5000 Pieces	<u>1731120733</u>
FCT Machined Contact, Female, Crimp, 0.20µm Gold Plating, Split Tine, 28-26 AWG, 1000 Pieces	<u>1731120734</u>
FCT Machined Contact, Female, Crimp, 0.20µm Gold Plating, Split Tine, 28-26 AWG, 5000 Pieces	<u>1731120735</u>
FCT Machined Contact, Female, Crimp, 0.80µm Gold Plating, Split Tine, 28-26 AWG, 1000 Pieces	<u>1731120736</u>
FCT Machined Contact, Female, Crimp, 1.30µm Gold Plating, Split Tine, 24-20 AWG, 1000 Pieces	<u>1731121740</u>

FCT Machined Contact, Female, Crimp, 1.30µm Gold over Copper Mating Plating, Non-Magnetic, Split Tine, 24-20 AWG, 500 Pieces	<u>1731140216</u>
---	-------------------

This document was generated on Apr 17, 2025