

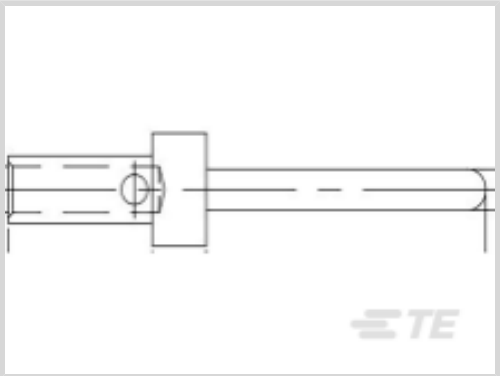

Connectors > Contacts > Connector Contacts



Contact Type: **Pin**
Contact Mating Area Plating Material: **Gold (Au)**
Contact Retention Type Within Housing: **Snap-In**
Contact Size: **Size 20**
Wire Size: **24 – 20 AWG**

Features

Contact Features

| | |
|--------------------------------------|-----------|
| Contact Underplating Material | Nickel |
| Contact Type | Pin |
| Contact Mating Area Plating Material | Gold (Au) |
| Contact Size | Size 20 |
| Contact Base Material | Brass |
| Contact Current Rating (Max) | 7.5 A |

Termination Features

| | |
|------------------------------------|--------------|
| Termination Method to Wire & Cable | Crimp |
| Product Terminates To | Wire & Cable |

Mechanical Attachment

| | |
|---------------------------------------|---------|
| Contact Retention Type Within Housing | Snap-In |
|---------------------------------------|---------|

Dimensions

| | |
|--------------------------------------|--------------------------------|
| Compatible Insulation Diameter Range | 1.07 – 1.85 mm[.042 – .073 in] |
| Wire Size | .2 – .6 mm ² |

Usage Conditions

| | |
|-----------------------------|----------------------------|
| Operating Temperature Range | -65 – 125 °C[-85 – 257 °F] |
|-----------------------------|----------------------------|

Operation/Application

| |
|--|
| |
|--|



| | |
|---------------------|----------------|
| Circuit Application | Power & Signal |
|---------------------|----------------|

Product Compliance

For compliance documentation, visit the product page on TE.com>

| | |
|---|--|
| EU RoHS Directive 2011/65/EU | Compliant with Exemptions |
| EU ELV Directive 2000/53/EC | Compliant with Exemptions |
| China RoHS 2 Directive MIIT Order No 32, 2016 | Restricted Materials Above Threshold |
| EU REACH Regulation (EC) No. 1907/2006 | Current ECHA Candidate List: JAN 2025 (247) Candidate List Declared Against: JAN 2025 (247) SVHC > Threshold: Pb (3.7% in 74018819) Article Safe Usage Statements: Do not eat, drink or smoke when using this product. Wash thoroughly after handling. Recycle if possible and dispose of the article by following all applicable governmental regulations relevant to your geographic location. |
| Halogen Content | Low Halogen - Br, Cl, F, I < 900 ppm per homogenous material. Also BFR/CFR/PVC Free |
| Solder Process Capability | Not applicable for solder process capability |

Product Compliance Disclaimer

This information is provided based on reasonable inquiry of our suppliers and represents our current actual knowledge based on the information they provided. This information is subject to change. The part numbers that TE has identified as EU RoHS compliant have a maximum concentration of 0.1% by weight in homogenous materials for lead, hexavalent chromium, mercury, PBB, PBDE, DBP, BBP, DEHP, DIBP, and 0.01% for cadmium, or qualify for an exemption to these limits as defined in the Annexes of Directive 2011/65/EU (RoHS2). Finished electrical and electronic equipment products will be CE marked as required by Directive 2011/65/EU. Components may not be CE marked. Additionally, the part numbers that TE has identified as EU ELV compliant have a maximum concentration of 0.1% by weight in homogenous materials for lead, hexavalent chromium, and mercury, and 0.01% for cadmium, or qualify for an exemption to these limits as defined in the Annexes of Directive 2000/53/EC (ELV). Regarding the REACH Regulation, the information TE provides on SVHC in articles for this part number is based on the latest European Chemicals Agency (ECHA) ‘Guidance on requirements for substances in articles’ posted at this URL: <https://echa.europa.eu/guidance-documents/guidance-on-reach>

Customers Also Bought



TE Part #4407170001
TMS-SCE-3/32-2.0-4



TE Part #115751-000
202D132-100/180-0



TE Part #5-146252-3
06 MODII HDR DRST B/A .100 LF



TE Part #4-87456-9
04 MODIV HSG COMP DR .100CL



TE Part #867779-1
LGH SOCKET HSG ASSY

TE Part #87165-1
LOCKING CLIP ASSY .025 SQ LP

TE Part #350690-1
UMNL PIN 24-18 PTPBR L/P

TE Part #85969-8
MOD IV RECP PLTD 30 SEL

TE Part #A20589-000
CHA-0305

TE Part #1-87175-4
06 LOCKING CLIP HSG SR .100CL

Documents

Product Drawings

LGH CONTACT PIN

English

CAD Files

3D PDF

3D

Customer View Model

ENG_CVM_CVM_867782-2_A.2d_dxf.zip

English

Customer View Model

ENG_CVM_CVM_867782-2_A.3d_igs.zip

English

Customer View Model

ENG_CVM_CVM_867782-2_A.3d_stp.zip

English

By downloading the CAD file I accept and agree to the [Terms and Conditions](#) of use.